

Technical Data Brochure ZTR 424

IMPORTANT - READ OPERATOR'S MANUAL BEFORE OPERATION.

Deluxe Seat Adjustment

Easy hand lever allows forward and back movement of seat.
No bolts to loosen or tighten.

Mower Blade Operation

To start mower blades, pull out on blade drive switch handle, then lift to "ON" position.

To stop mower blades, move switch handle to "OFF" position.

Body Removal

1. Disconnect throttle cable from engine.
2. Disconnect the rear wiring loom (P/N 4191) from the body by lightly squeezing the Econo-Seal plug. This plug is located at the left rear of the body.
3. Remove 4 control lever bolts and remove upper control levers (P/N 1501L-1501R).
4. Remove the 2 attach nuts on floor of body and unfasten latch located at center of body at the rear.
5. Place height adjustment lever in vertical position, engage parking brake and carefully lift body up and off chassis,
6. Reverse the above procedure for assembly.

Safety Checks

1. After reassembly, while on seat, attempt to start engine with mower deck engaged. Engine should not start. If engine does start, return to an authorized Dixon dealer for adjustment or repair.
2. Disengage the mower deck and start the engine. With operator in normal mowing position, engage mower deck and remove weight from seat. The engine should stop. If engine does not stop when operator rises from seat, return to an authorized Dixon dealer for adjustment or repair.

Parking Brake Adjustment

Remove body as described above. Adjustment points are located at rear of trans-axle on each side. Remove cotter pin from swivel fitting (P/N 2172). Turn swivel fitting on brake rod (P/N 5100) in to tighten - just enough to prevent brake from slipping when engaged. **CAUTION:** Over tightening may cause premature wear on brake band (P/N 5085).

Mower Drive Belt Adjustment

No adjustment necessary, the spring-loaded idler pulley maintains proper tension throughout the belt life.

Removing Mower Deck

1. Remove mower deck drive belt (P/N 6111) by pulling idler assembly (P/N 1688) away from belt and remove belt from rear pulley.
2. Remove 4 attach pins (P/N 6107) and clips from 4 mower deck attach points and 2 stabilizer bars (P/N 6159).
3. Raise front of mower chassis and roll free of mower deck for service and/or replacement.
4. To re-install, reverse the above procedure.

Removing Mower Cutter Blade

Secure mower cutter blade (P/N 6092) from turning (observe blade position when removing) remove blade bolt from center of blade.

PART #	NAME	PART #	NAME	PART #	NAME
1014	Caster Pipe Nipple	4005B	Throttle Cable	5073R	HD Support R
1015	Caster Weldment	4006-2	Solenoid-Starter Cable	5073L	HD Support L
1020	Caster Axle	4006-8	Solenoid-Battery Cable	5077	HD Cone Frame
1022	Caster Wheel & Tire	4006-9	Battery Ground Cable	5079	HD Transaxle Pulley
1022A	Caster Wheel Bearing	4007-1	Battery - 12V	5080	Rear Tube Weld.
1030	Upper Lift Link-Rear	4009	Wire Clip(not shown)	5084	Brake Drum
1039	Lower Lift Link	4011-1	Name Decal	5085	Brake Band
1094	Tie Bar	4013	Wire Tie (not shown)	5086	Brake Spacer 5/8
1096	Frame Weldment	4025	Switch Decal	5087	Brake Spacer 3/8
1108	Tire- Front Wheel	4047	Seat Switch	5088	Brake Shaft Weld
1109	Inner Tube-Front Wheel	4058	Arm Rest Bracket-R	5097	Brake Lever Weld
1501R	Upper Control Lever	4059	Arm Rest Bracket-L	5100	Brake Rod
1501L	Upper Control Lever	4065	Model Decal-ZTR 424	5101	Brake Link
1502	Control Rod Assy.	4067	Ignition Switch	5103	Eye Bolt
1504	Wheel Hub	4067A	Switch Key (for 4067)	6058	V-Pulley
1506	Hub Flange	4075	10 AMP Fuse	6059	Flat Idler Pulley
1507	Wheel/Deck Hub Bearing	4076	Headlight Assembly	6065	Serpentine Idler
1509	Rear Wheel & Tire	4077	Headlight-Sealed beam only	6077-1	Bearing Spacer
1511	Rear Rim(18x9.50-8)	4079	Body Switch	6078	Pulley Spacer
1512	Rear Tire(18x9.50-8)	4082	Switch Bracket-Body	6087-1	Engaging Rod
1535	Drive Chain	4083	Switch Bracket-Switch Sect.	6089	Engaging Handle
1536	Chain Connecting Link	4092	Fuse Holder	6092	Mower Blade
1540	Engine Shaft Key	4093	Body Wiring Loom	6093-1	Outer Hub Assy.
1543	Lift Knob	4109	Rear Wiring Loom	6094-1	Deck Hub Casting
1544	Bellcrank	4113	Wiring Kit	6095-1	Center Shaft
1552	Belt Keeper Weldment	4124	Solenoid	6097-1	Outer Shaft
1630	Bumper	4138	Seat Back-Tapered	6100	Outer Shaft Key
1638	Lower Control Lever Assy.	4139	Arm Rest-Offset	6101	Center Shaft Key
1646	Weight Brace	4143	Seat Bottom	6107	Deck Pin
1647	Control Pin	4144	Slide w/o Adjuster	6108-1	Center Hub Assy.
1654	Transaxle Idler Weld.	4145	Slide w/ Adjuster	6109	V-Belt
1655	Transaxle Idler Pulley	4146	Nylon Washer	6111	Beck Drive Belt
1657	Transaxle Idler Spring	4147	Body	6113	Blade Washer
1664	Transaxle Drive Belt	4149	Utility Box	6127	Deflector Weldme
1665	Double Engine Pulley	4150	Utility Box Bottom	6134	Engaging Spring
1666	Battery Strap	4151	Utility Box Trim	6135	5/16" Turnbuckle
2159	Engaging Idler Spacer	5002	Front Tube	6136-2	Engaging Cam Wel
2166	Pivot Bolt	5005	Discup	6148A	Connecting Arm A
2172	Swivel Fitting	5008	Transaxle-HD w/Brake	6151	Bearing
2221	Transaxle Shim-16ga	5009R	Cradle	6156	Serp. Idler Weld
2222	Transaxle Shim-22ga	5009L	Cradle	6158	Serp. Idler Assy
2413	V-Idler Pulley	5011	Support Shaft	6159	Stabilizer Arm
2460	Parking Brake Decal	5012	Cradle Shaft	6161	Idler Arm Weld.
2823	Oil Drain Assy.	5014-1	Torque Rod	6164	Bronze Bshg.
3029	Front Grommet	5015	24T Sprocket	6165	Mower Deck Weld.
3502	Hand Grip	5016	Molded Cone	6166	Mower Deck Assy.
3504	Double Ball Joint	5018	9T Sprocket-Narrow	6167	Hub Sub Assy.
3507	Floor Pad - Long	5019	Transaxle Chain		
3508	Floor Pad - Short	5021	9T Sprocket-Wide		
3511	Adhesive Bumper Pad	5024-1	Cradle Spring		
3521	Engaging Cam Mount Bshg.	5028	Transaxle Bearing		
3531	Decal-Operating Inst.	5036	Pivot Spring		
3532	Decal-Blade Drive	5044	Torque Rod Stiffener L		
3536	Warning Label-Danger	5045	-Torque Rod Stiffener R		
3552	Tank Mount Bracket-Long	5046	Positive Neutral Rod		
3553	Tank Mount Bracket-Short	5047	Positive Neutral Spring		
3554	Fuel Cap/Gauge	5059	Double Bearing		
3556	Tank Support L	5066	HD Cone Frame Shaft		
3557	Tank Support R	5068	HD Pulley Spacer		
3558	2 Gal. Tank w/cap/gauge	5070	Transaxle Key		

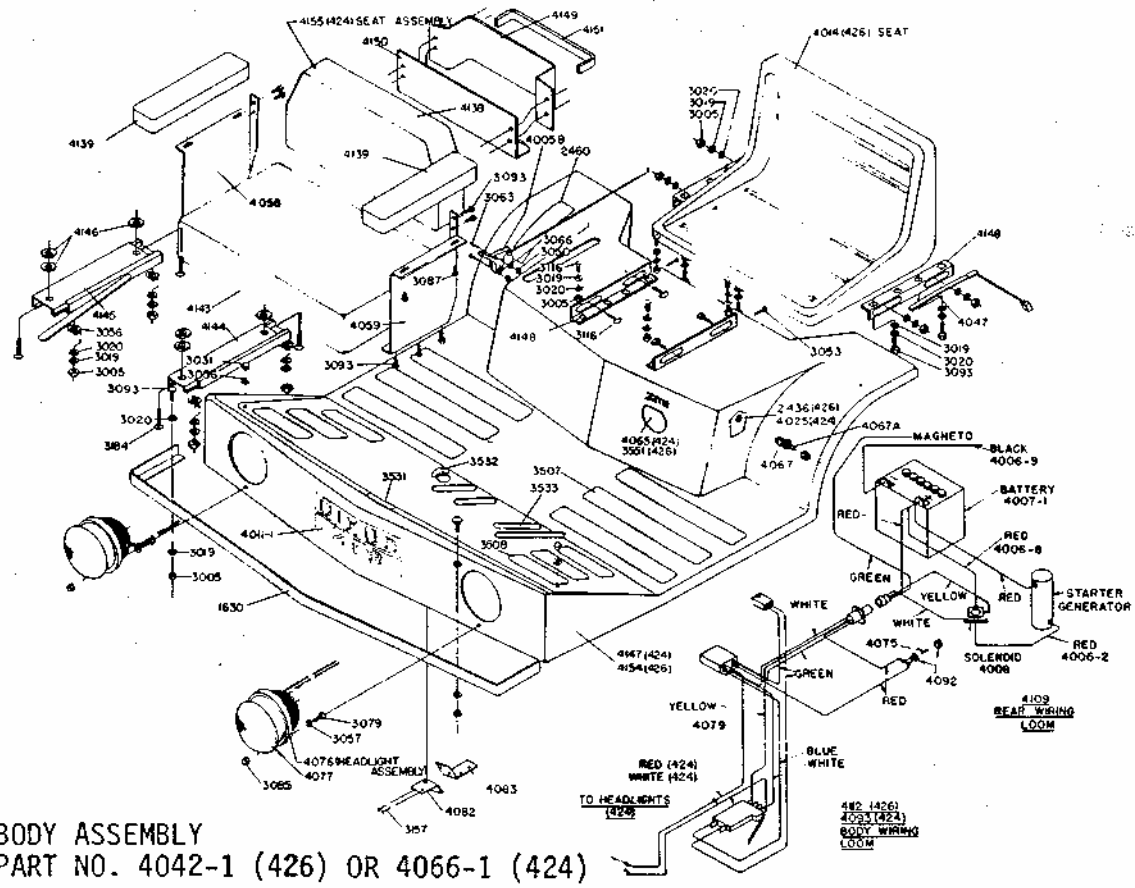

BODY ASSEMBLY
PART NO. 4042-1 (426) OR 4066-1 (424)

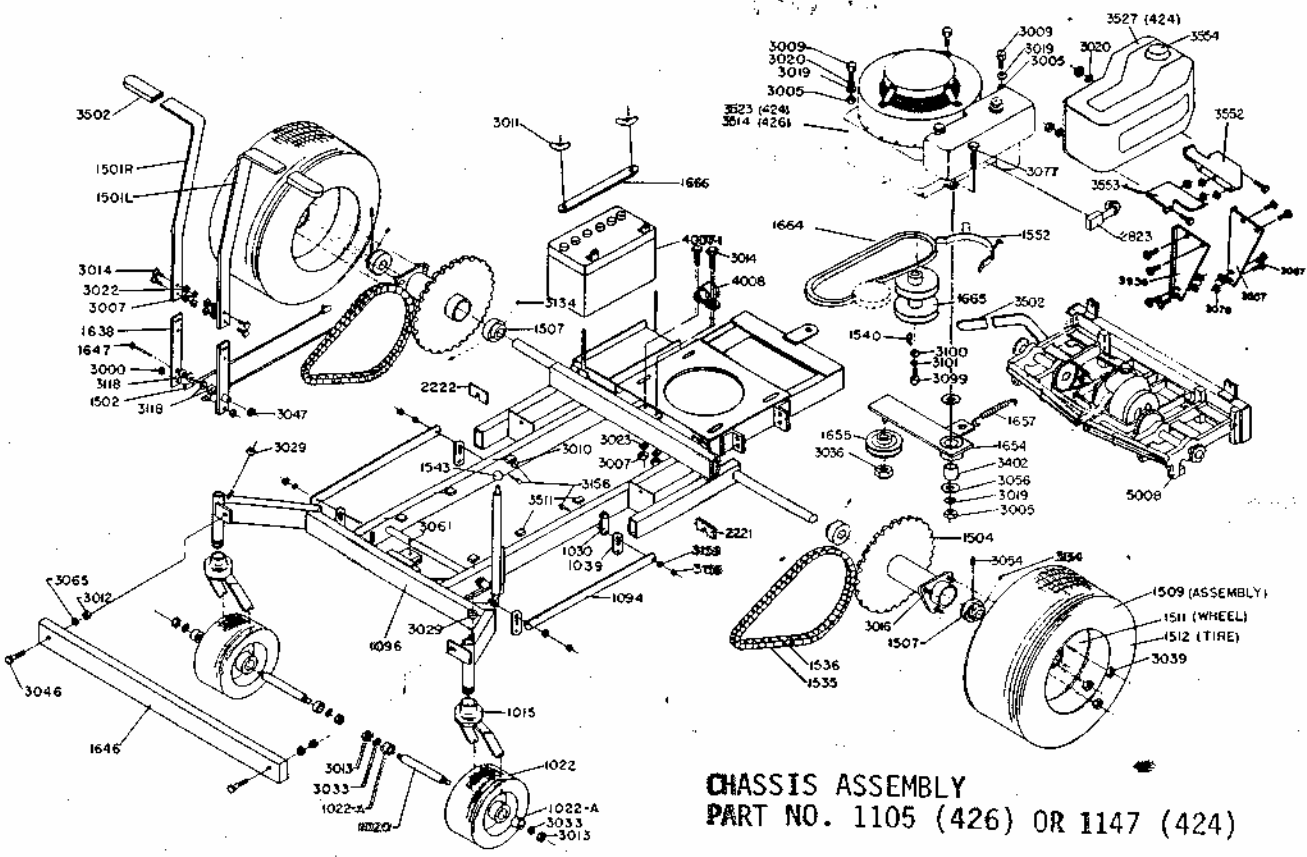

CHASSIS ASSEMBLY
PART NO. 1105 (426) OR 1147 (424)

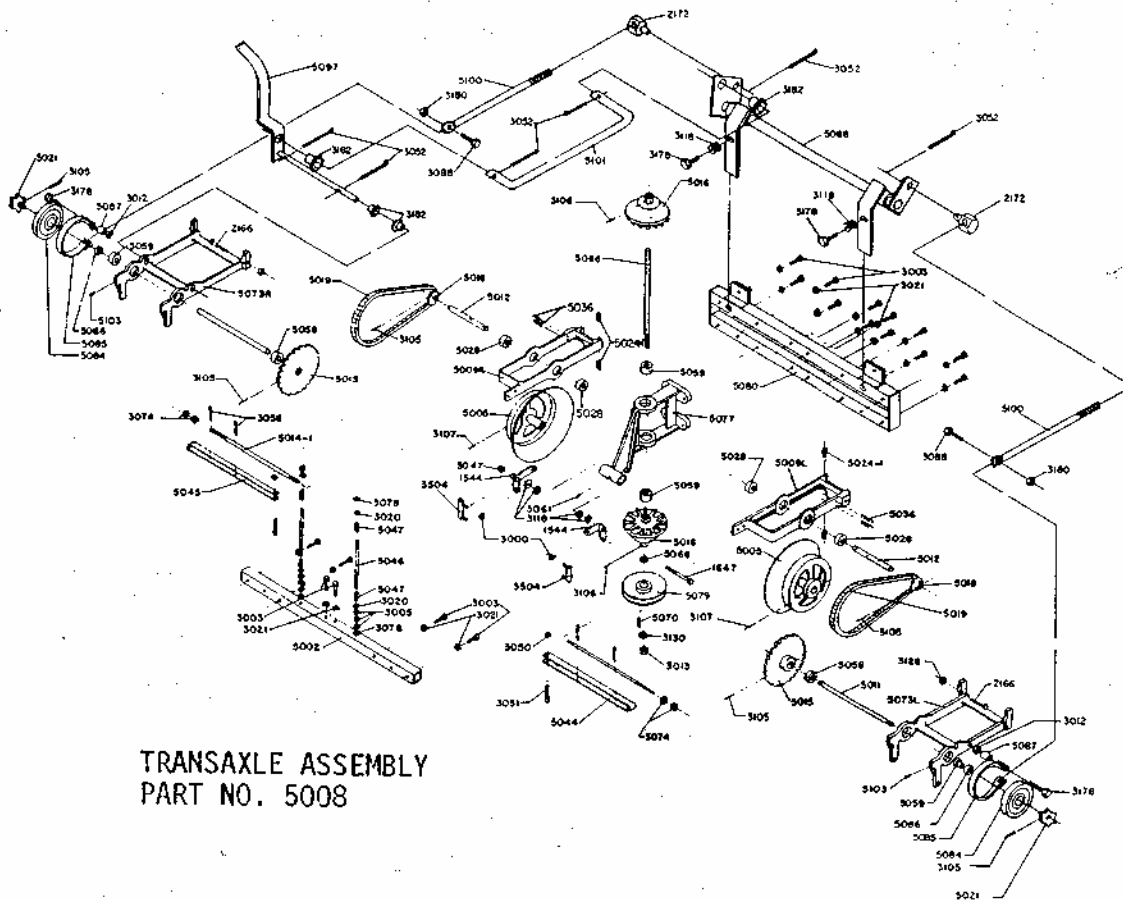

TRANSAXLE ASSEMBLY
PART NO. 5008

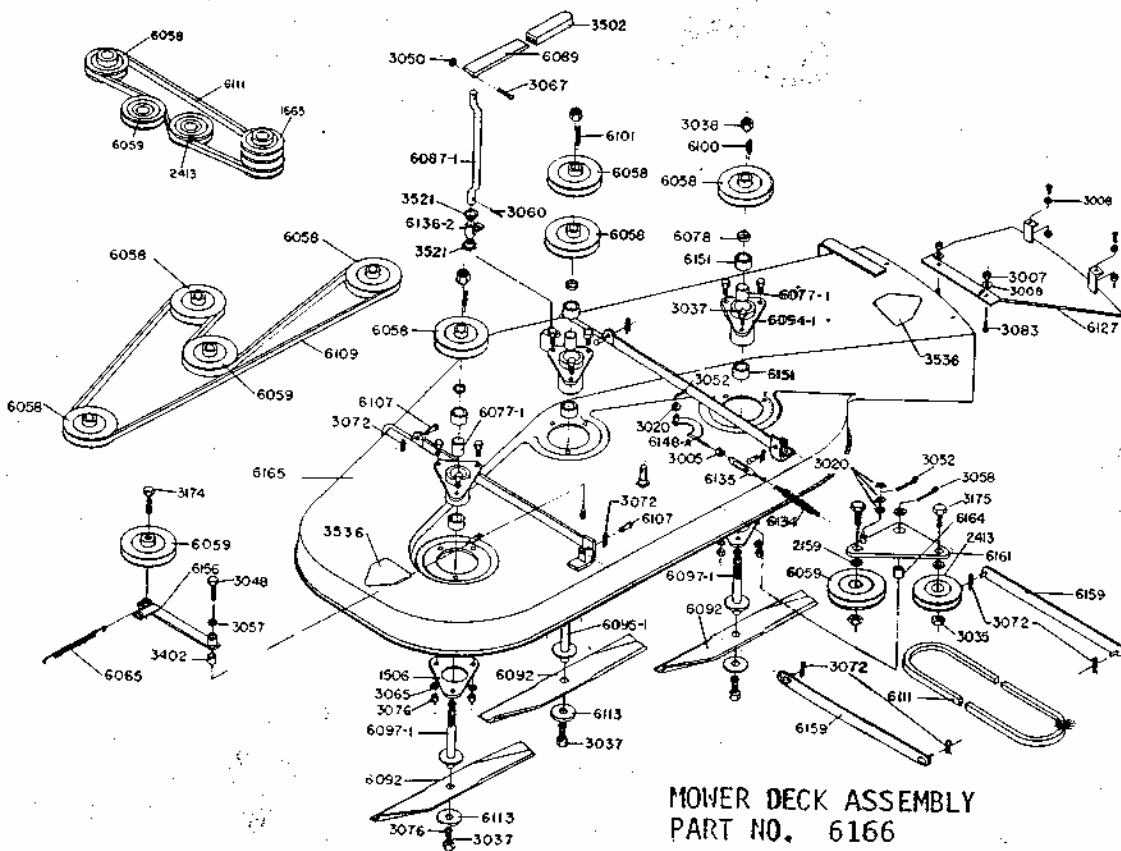

MOWER DECK ASSEMBLY
PART NO. 6166